

FREEHOLD



House - Semi-Detached (EPC Rating: B)

29 LOUISE RISE, FAIRFIELD, HITCHIN, HERTS, SG5 4SE

Price Guide

£439,000



First Step



3



2



1



B

3 Bedroom House - Semi-Detached located in Fairfield, Hitchin

BEAUTIFULLY PRESENTED semi-detached home... SEPARATE STUDY... Garage Plus Driveway... SECLUDED Rear Garden... LIVING Room with FRENCH DOORS to GARDEN... EN-SUITE... EXCELLENT STORAGE...

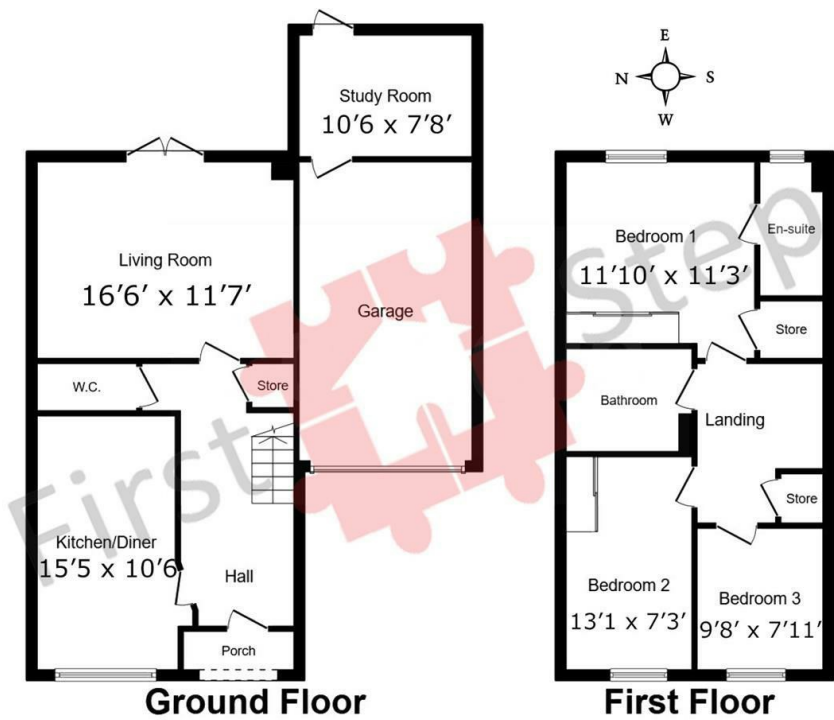

This floor plan is for illustrative purposes only. It is not drawn to scale. Any measurements, floor areas (including any total floor area), openings and orientation are approximate. No details are guaranteed, they cannot be relied upon for any purpose and they do not form part of any agreement. No liability is taken for any error, omission or misstatement. A party must rely upon its own inspection(s). Plan produced for Connells. Powered by www.focalagent.com

Council Tax Band
D
 Energy Performance Graph

Call us on
01462 659 730
sales@firststep.ltd
www.firststep.ltd

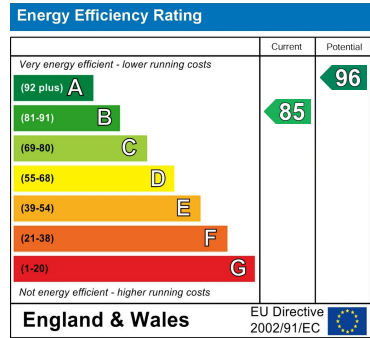

Agents Note: Whilst every care has been taken to prepare these particulars, they are for guidance purposes only. All measurements are approximate and are for general guidance purposes only and whilst every care has been taken to ensure their accuracy, they should not be relied upon and potential buyers are advised to recheck the measurements.